

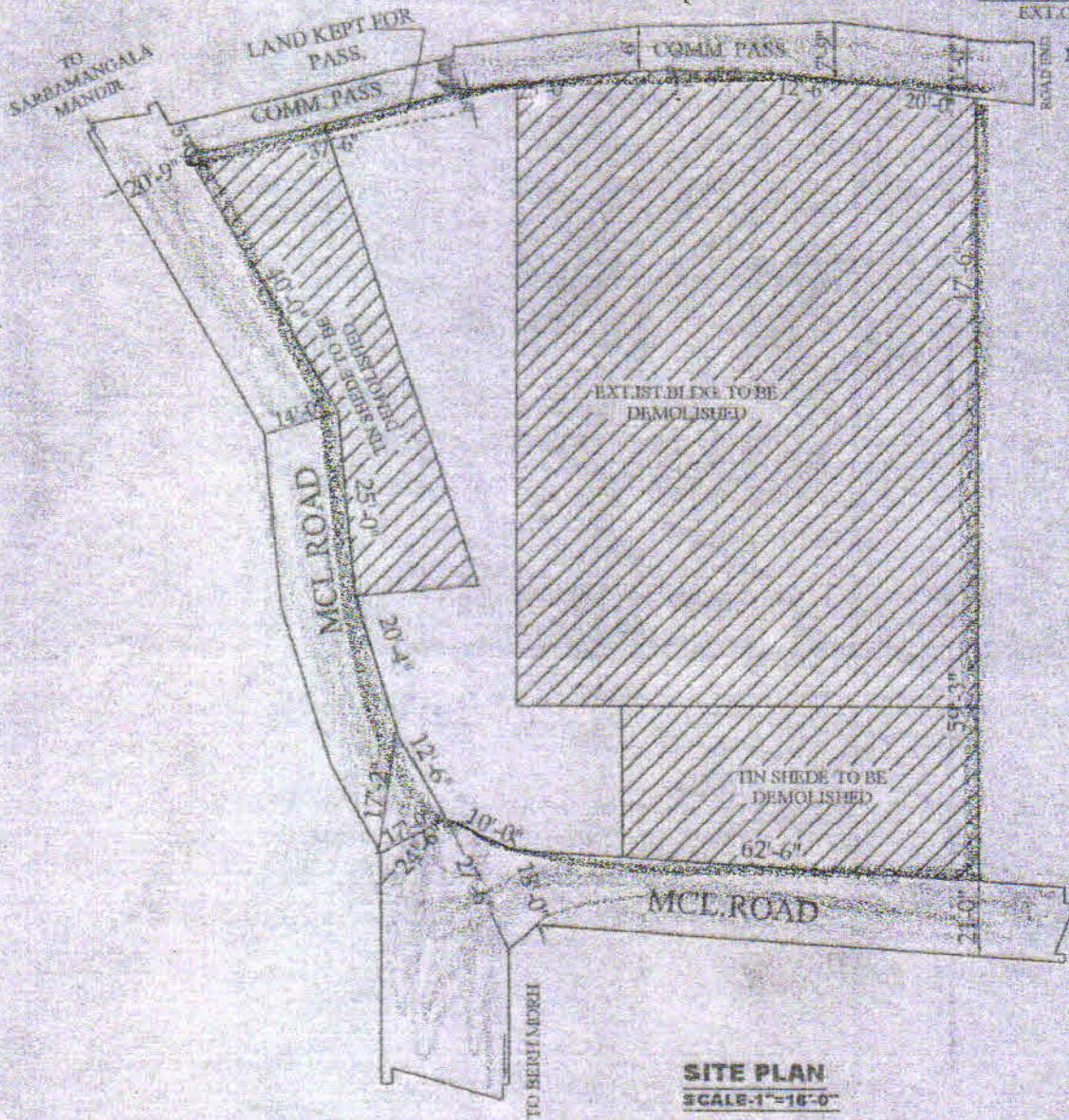

SITE PLAN FOR THE PROPOSED G+VII STORED RESIDENTIAL FLAT BUILDING OF 1) SMT. ANURADHA KUNDU W/O LATE NISHITH KR. KUNDU, 2) ARPITA KUNDU & 3) SANCHITA KUNDU BOTH ARE D/O LATE NISHITH KR. KUNDU, ON MOUZA:- BHATCHALA, J.L. NO.-37, R.S. PLOT NO.:-131, L.R. PLOT NO:- 480 & 481, L.R. KH. NO:-2947,3304,3305, AT MAHALLA:- BHATCHALA, HOLDING NO- 348, WARD NO:-35, P.S. - BURDWAN, DIST. - PURBA BARDHAMAN, UNDER BURDWAN MUNICIPALITY.

AREA OF LAND:- 2362.49 SQT
 NATURE OF LAND:- BASTI
 OWNER LAND SHOWN IN COLOUR
 EXT. CONST. SHOWN IN COLOUR
 ROAD SHOWN IN COLOUR
 DRAIN SHOWN IN COLOUR

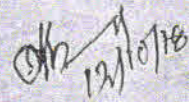
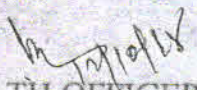
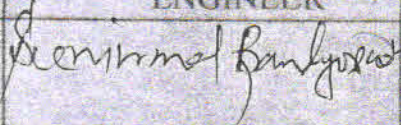

		<input checked="" type="checkbox"/> Anuradha Kundu <input checked="" type="checkbox"/> Sanchita Sarkar
VICE - CHAIRMAN	ENGINEER	<input checked="" type="checkbox"/>
 HEALTH OFFICER	 DRAWN BY	<input checked="" type="checkbox"/> Arpita Chakraborty SIG. OF OWNERS